

HEXAGON SOCKET HEAD CAP SCREWS - STEEL

CILINDERSCHROEVEN MET BINNENZESKANT - STAAL

VIS A TETE CYLINDRIQUE A SIX PANS CREUX - ACIER

TORNILLOS DE CABEZA CILINDRICA CON HUECO HEXAGONAL - ACERO

ZYLINDERSCHRAUBEN MIT INNENSECHSKANT - STAHL

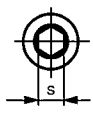
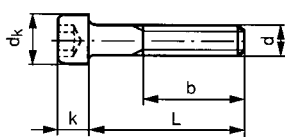

ISO : 4762
 DIN : 912
 NEN : 1241
 ANSI : B18.3.1M
 BS : 4168-1
 NF : E25-125

GROUPCODE

STEEL ☒ **07000**
 STEEL ☒☒ **07005**

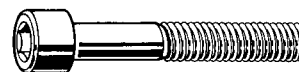

Ordering example:
07000 M1,6 x 3

M
St
12.9

	M5	M6	M8
d			
P	0,8	1	1,25
b①	22	24	28
dk (max.)	8,5	10	13
k (max.)	5	6	8
s	4	5	6

SMALL PACKING

DIMENSION CODE

d x L	STEEL 07000 D01	☒	d x L	STEEL 07000 D01	☒	d x L	STEEL 07000 D01	☒
M5 x 6	050.006	200	M6 x 10	060.010	200	M8 x 10	080.010	200
M5 x 8	050.008	200	M6 x 12	060.012	200	M8 x 12	080.012	200
M5 x 10	050.010	200	M6 x 16	060.016	200	M8 x 16	080.016	200
M5 x 12	050.012	200	M6 x 18	060.018	200	M8 x 18	080.018	200
M5 x 16	050.016	200	M6 x 20	060.020	200	M8 x 20	080.020	200
M5 x 20	050.020	200	M6 x 25	060.025	200	M8 x 25	080.025	200
M5 x 22	050.022	200	M6 x 30	060.030	200	M8 x 30	080.030	200
M5 x 25	050.025	200				M8 x 35	080.035	200
.....			M6 x 35	060.035	200		
M5 x 30	050.030	200	M6 x 40	060.040	200	M8 x 40	080.040	200
M5 x 35	050.035	200	M6 x 45	060.045	200	M8 x 45	080.045	200
M5 x 40	050.040	200	M6 x 50	060.050	200	M8 x 50	080.050	200
M5 x 45	050.045	200	M6 x 55	060.055	200	M8 x 55	080.055	200
M5 x 50	050.050	200	M6 x 60	060.060	200	M8 x 60	080.060	200
M5 x 55	050.055	200	M6 x 65	060.065	200	M8 x 65	080.065	200
M5 x 60	050.060	200	M6 x 70	060.070	200	M8 x 70	080.070	200
M5 x 70	050.070	200	M6 x 75	060.075	200	M8 x 75	080.075	200
M5 x 80	050.080	200	M6 x 80	060.080	200	M8 x 80	080.080	200
M5 x 90	050.090	200	M6 x 90	060.090	100	M8 x 90	080.090	100
M5 x 100	050.100	200	M6 x 100	060.100	100	M8 x 100	080.100	100
M5 x 110	050.110	200	M6 x 110	060.110	50	M8 x 110	080.110	50
M5 x 120	050.120	100	M6 x 120	060.120	50	M8 x 120	080.120	50
M5 x 140	050.140	25	M6 x 130	060.130	50	M8 x 140	080.140	50
M5 x 160	050.160	25	M6 x 140	060.140	25	M8 x 150	080.150	50
M5 x 180	050.180	25	M6 x 160	060.160	25	M8 x 160	080.160	50
M5 x 200	050.200	25	M6 x 180	060.180	25	M8 x 180	080.180	50
M6 x 8	060.008	200	M6 x 200	060.200	25	M8 x 200	080.200	50

LARGE PACKING

DIMENSION CODE

d x L	STEEL 07005 D01	☒☒	d x L	STEEL 07005 D01	☒☒	d x L	STEEL 07005 D01	☒☒
M5 x 6	050.006	500	M5 x 45	050.045	500	M6 x 25	060.025	500
M5 x 8	050.008	500	M5 x 50	050.050	500	M6 x 30	060.030	500
M5 x 10	050.010	500	M5 x 60	050.060	500		
M5 x 12	050.012	500	M5 x 70	050.070	500	M6 x 35	060.035	500
M5 x 16	050.016	500				M6 x 40	060.040	500
M5 x 20	050.020	500	M6 x 8	060.008	500	M6 x 45	060.045	500
M5 x 25	050.025	500	M6 x 10	060.010	500	M6 x 50	060.050	500
.....			M6 x 12	060.012	500	M6 x 55	060.055	500
M5 x 30	050.030	500	M6 x 16	060.016	500	M6 x 60	060.060	500
M5 x 35	050.035	500	M6 x 18	060.018	500	M6 x 70	060.070	500
M5 x 40	050.040	500	M6 x 20	060.020	500			

① Size **b** is a guide value, it amounts on the **minimum** length of the threaded part.
 Per diameter (d) are lengths (L) above the dotted line fully threaded. (L – b = max. 3P).
 For other sizes with full thread, see elsewhere in the section.
WARNING: electro-galvanizing of these products may cause hydrogen embrittlement.

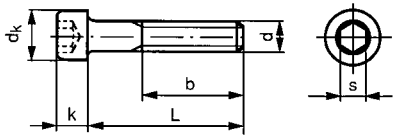
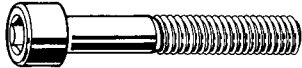

HEXAGON SOCKET HEAD CAP SCREWS - STEEL
 CILINDERSCHROEVEN MET BINNENZESKANT - STAAL
 VIS A TETE CYLINDRIQUE A SIX PANS CREUX - ACIER
 TORNILLOS DE CABEZA CILINDRICA CON HUECO HEXAGONAL - ACERO
 ZYLINDERSCHRAUBEN MIT INNENSECHSKANT - STAHL

	ISO : 4762 DIN : 912 NEN : 1241 ANSI : B18.3.1M BS : 4168-1 NF : E25-125	GROUPCODE STEEL ☒ 07000 STEEL ☒☒ 07005	 Ordering example: 07000 M1,6 x 3	M St 12.9
--	---	---	--	--------------------------------------

	←	M10	M12	M14	M16	→
P		1,5	1,75	2	2	
b①		32	36	40	44	
dk (max.)		16	18	21	24	
k (max.)		10	12	14	16	
s		8	10	12	14	

SMALL PACKING **DIMENSION CODE**

d x L	STEEL 07000	☒	d x L	STEEL 07000	☒	d x L	STEEL 07000	☒
	D01			D01			D01	
M10 x 12	100.012	200	M12 x 50	120.050	100	M14 x 90	140.090	50
M10 x 16	100.016	200				M14 x 100	140.100	50
M10 x 20	100.020	200	M12 x 55	120.055	100	M14 x 110	140.110	25
M10 x 25	100.025	200	M12 x 60	120.060	100	M14 x 120	140.120	25
M10 x 30	100.030	200	M12 x 65	120.065	50	M14 x 130	140.130	25
M10 x 35	100.035	100	M12 x 70	120.070	50	M14 x 140	140.140	25
M10 x 40	100.040	100	M12 x 75	120.075	50	M14 x 150	140.150	25
			M12 x 80	120.080	50	M14 x 160	140.160	25
M10 x 45	100.045	100	M12 x 90	120.090	50	M14 x 180	140.180	10
M10 x 50	100.050	100	M12 x 100	120.100	50	M14 x 200	140.200	10
M10 x 55	100.055	100	M12 x 110	120.110	50			
M10 x 60	100.060	100	M12 x 120	120.120	50	M16 x 20	160.020	50
M10 x 65	100.065	100	M12 x 130	120.130	25	M16 x 25	160.025	50
M10 x 70	100.070	100	M12 x 140	120.140	25	M16 x 30	160.030	50
M10 x 75	100.075	100	M12 x 150	120.150	25	M16 x 35	160.035	50
M10 x 80	100.080	100	M12 x 160	120.160	25	M16 x 40	160.040	50
M10 x 90	100.090	100	M12 x 180	120.180	10	M16 x 45	160.045	50
M10 x 100	100.100	100	M12 x 200	120.200	10	M16 x 50	160.050	50
M10 x 110	100.110	50	M12 x 220	120.220	10	M16 x 55	160.055	50
M10 x 120	100.120	50	M12 x 225	120.225	10	M16 x 60	160.060	50
M10 x 130	100.130	50	M12 x 240	120.240	10			
M10 x 140	100.140	25	M12 x 260	120.260	10	M16 x 65	160.065	25
M10 x 150	100.150	25	M12 x 280	120.280	10	M16 x 70	160.070	25
M10 x 160	100.160	25	M12 x 300	120.300	10	M16 x 75	160.075	25
M10 x 180	100.180	25				M16 x 80	160.080	25
M10 x 200	100.200	25	M14 x 20	140.020	100	M16 x 90	160.090	25
M10 x 220	100.220	25	M14 x 25	140.025	100	M16 x 100	160.100	25
M10 x 225	100.225	25	M14 x 30	140.030	100	M16 x 110	160.110	25
M10 x 240	100.240	10	M14 x 35	140.035	100	M16 x 120	160.120	25
M10 x 250	100.250	10	M14 x 40	140.040	100	M16 x 130	160.130	25
M10 x 260	100.260	10	M14 x 45	140.045	50	M16 x 140	160.140	25
M10 x 300	100.300	10	M14 x 50	140.050	50	M16 x 150	160.150	10
			M14 x 55	140.055	50	M16 x 160	160.160	10
M12 x 16	120.016	100				M16 x 180	160.180	10
M12 x 20	120.020	100	M14 x 60	140.060	50	M16 x 200	160.200	10
M12 x 25	120.025	100	M14 x 65	140.065	50	M16 x 220	160.220	10
M12 x 30	120.030	100	M14 x 70	140.070	50	M16 x 240	160.240	5
M12 x 35	120.035	100	M14 x 75	140.075	50	M16 x 260	160.260	5
M12 x 40	120.040	100	M14 x 80	140.080	50	M16 x 300	160.300	5
M12 x 45	120.045	100						

① Size **b** is a guide value, it amounts on the **minimum** length of the threaded part.
 Per diameter (d) are lengths (L) above the dotted line fully threaded. (L – b = max. 3P).
 For other sizes with full thread, see elsewhere in the section.
WARNING: electro-galvanizing of these products may cause hydrogen embrittlement.

HEXAGON SOCKET HEAD CAP SCREWS - STEEL

CILINDERSCHROEVEN MET BINNENZESKANT - STAAL

VIS A TETE CYLINDRIQUE A SIX PANS CREUX - ACIER

TORNILLOS DE CABEZA CILINDRICA CON HUECO HEXAGONAL - ACERO

ZYLINDERSCHRAUBEN MIT INNENSECHSKANT - STAHL

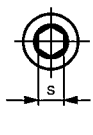
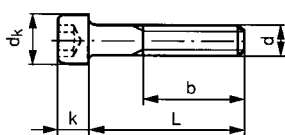

ISO : 4762
 DIN : 912
 NEN : 1241
 ANSI : B18.3.1M
 BS : 4168-1
 NF : E25-125

GROUPCODE

STEEL ☒ 07000
 STEEL ☒☒ 07005

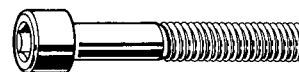

Ordering example:
 07000 M1,6 x 3

M
St
12.9

	M18	M20	M22	M24
d	18	20	22	24
P	2,5	2,5	2,5	3
b①	48	52	56	60
dk (max.)	27	30	33	36
k (max.)	18	20	22	24
s	14	17	17	19

SMALL PACKING

DIMENSION CODE

d x L	STEEL 07000 D01	☒	d x L	STEEL 07000 D01	☒	d x L	STEEL 07000 D01	☒
M18 x 40	180.040	50	M20 x 150	200.150	10	M22 x 300	220.300	5
M18 x 45	180.045	50	M20 x 160	200.160	10	M24 x 30	240.030	10
M18 x 50	180.050	50	M20 x 180	200.180	10	M24 x 40	240.040	10
M18 x 60	180.060	25	M20 x 190	200.190	10	M24 x 45	240.045	10
.....	M20 x 200	200.200	10	M24 x 50	240.050	10
M18 x 70	180.070	25	M20 x 210	200.210	10	M24 x 55	240.055	10
M18 x 80	180.080	25	M20 x 220	200.220	5	M24 x 60	240.060	10
M18 x 90	180.090	25	M20 x 240	200.240	5	M24 x 65	240.065	10
M18 x 100	180.100	25	M20 x 250	200.250	5	M24 x 70	240.070	10
M18 x 110	180.110	25	M20 x 260	200.260	5	M24 x 75	240.075	10
M18 x 120	180.120	25	M20 x 270	200.270	5	M24 x 80	240.080	10
M18 x 140	180.140	25	M20 x 280	200.280	5
M18 x 160	180.160	10	M20 x 290	200.290	5	M24 x 85	240.085	10
M18 x 180	180.180	10	M20 x 300	200.300	5	M24 x 90	240.090	10
M18 x 190	180.190	10	M20 x 310	200.310	5	M24 x 100	240.100	10
M18 x 200	180.200	10	M20 x 320	200.320	5	M24 x 110	240.110	10
.....	M20 x 340	200.340	5	M24 x 120	240.120	5
M20 x 30	200.030	25	M20 x 360	200.360	5	M24 x 130	240.130	5
M20 x 35	200.035	25	M20 x 380	200.380	5	M24 x 140	240.140	5
M20 x 40	200.040	25	M20 x 400	200.400	5	M24 x 150	240.150	5
M20 x 45	200.045	25	M24 x 160	240.160	5
M20 x 50	200.050	25	M22 x 40	220.040	10	M24 x 180	240.180	5
M20 x 55	200.055	25	M22 x 50	220.050	10	M24 x 200	240.200	5
M20 x 60	200.060	25	M22 x 60	220.060	10	M24 x 220	240.220	2
M20 x 65	200.065	25	M22 x 70	220.070	10	M24 x 240	240.240	2
M20 x 70	200.070	25	M24 x 250	240.250	2
.....	M22 x 80	220.080	10	M24 x 260	240.260	2
M20 x 75	200.075	25	M22 x 100	220.100	10	M24 x 270	240.270	2
M20 x 80	200.080	25	M22 x 120	220.120	10	M24 x 280	240.280	2
M20 x 90	200.090	25	M22 x 140	220.140	10	M24 x 300	240.300	2
M20 x 95	200.095	25	M22 x 160	220.160	10	M24 x 320	240.320	2
M20 x 100	200.100	25	M22 x 180	220.180	10	M24 x 340	240.340	2
M20 x 110	200.110	25	M22 x 200	220.200	10	M24 x 360	240.360	2
M20 x 120	200.120	25	M22 x 210	220.210	5	M24 x 380	240.380	2
M20 x 130	200.130	25	M22 x 240	220.240	5	M24 x 400	240.400	2
M20 x 140	200.140	25	M22 x 260	220.260	5			

① Size **b** is a guide value, it amounts on the **minimum** length of the threaded part.
 Per diameter (d) are lengths (L) above the dotted line fully threaded. (L – b = max. 3P).
 For other sizes with full thread, see elsewhere in the section.

WARNING: electro-galvanizing of these products may cause hydrogen embrittlement.



HEXAGON SOCKET HEAD CAP SCREWS - STEEL

CILINDERSCHROEVEN MET BINNENZESKANT - STAAL

VIS A TETE CYLINDRIQUE A SIX PANS CREUX - ACIER

TORNILLOS DE CABEZA CILINDRICA CON HUECO HEXAGONAL - ACERO

ZYLINDERSCHRAUBEN MIT INNENSECHSKANT - STAHL

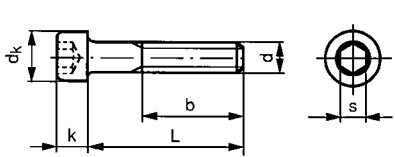
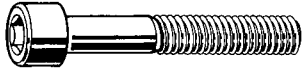
	ISO : 4762 DIN : 912 NEN : 1241 ANSI : B18.3.1M BS : 4168-1 NF : E25-125	GROUPCODE STEEL ☒ 07000 STEEL ☒☒ 07005	 Ordering example: 07000 M1,6 x 3	M St 12.9
--	---	---	--	--------------------------------------

d	M27	M30	M33	M36	M39 ^②	M42	M48
P	3	3,5	3,5	4	4	4,5	5
b ^①	66	72	78	84	90	96	108
dk (max.)	40	45	50	54	58	63	72
k (max.)	27	30	33	36	39	42	48
s	19	22	24	27	27	32	36

SMALL PACKING **DIMENSION CODE**

d x L	STEEL 07000 D01	☒	d x L	STEEL 07000 D01	☒	d x L	STEEL 07000 D01	☒
M27 x 50	270.050	2	M30 x 220	300.220	2	M36 x 300	360.300	1
M27 x 60	270.060	2	M30 x 240	300.240	2	M36 x 400	360.400	1
M27 x 70	270.070	2	M30 x 260	300.260	2	M36 x 420	360.420	1
M27 x 75	270.075	2	M30 x 280	300.280	2			
M27 x 80	270.080	2	M30 x 300	300.300	2	M39 x 80	390.080	1
M27 x 90	270.090	2	M30 x 400	300.400	1	M39 x 90	390.090	1
.....						M39 x 100	390.100	1
M27 x 100	270.100	2	M33 x 70	330.070	2			
M27 x 120	270.120	2	M33 x 80	330.080	2	M39 x 120	390.120	1
M27 x 140	270.140	2	M33 x 90	330.090	2	M39 x 140	390.140	1
M27 x 160	270.160	2	M33 x 100	330.100	2	M39 x 160	390.160	1
M27 x 170	270.170	2				M39 x 180	390.180	1
M27 x 180	270.180	2	M33 x 120	330.120	2	M39 x 200	390.200	1
M27 x 190	270.190	2	M33 x 130	330.130	2			
M27 x 200	270.200	2	M33 x 140	330.140	2	M42 x 90	420.090	1
M27 x 220	270.220	2	M33 x 160	330.160	2	M42 x 100	420.100	1
M27 x 240	270.240	2	M33 x 180	330.180	2	M42 x 120	420.120	1
M27 x 260	270.260	2	M33 x 200	330.200	2			
M27 x 300	270.300	2	M33 x 260	330.260	1	M42 x 140	420.140	1
M27 x 400	270.400	1	M33 x 280	330.280	1	M42 x 160	420.160	1
.....						M42 x 180	420.180	1
M30 x 60	300.060	2	M36 x 60	360.060	1	M42 x 200	420.200	1
M30 x 70	300.070	2	M36 x 80	360.080	1	M42 x 240	420.240	1
M30 x 80	300.080	2	M36 x 90	360.090	1	M42 x 260	420.260	1
M30 x 90	300.090	2	M36 x 100	360.100	1	M42 x 300	420.300	1
M30 x 100	300.100	2						
.....			M36 x 120	360.120	1	M48 x 120	480.120	1
M30 x 110	300.110	2	M36 x 140	360.140	1	M48 x 140	480.140	1
M30 x 120	300.120	2	M36 x 160	360.160	1	M48 x 150	480.150	1
M30 x 140	300.140	2	M36 x 180	360.180	1			
M30 x 150	300.150	2	M36 x 200	360.200	1	M48 x 160	480.160	1
M30 x 160	300.160	2	M36 x 220	360.220	1	M48 x 180	480.180	1
M30 x 170	300.170	2	M36 x 240	360.240	1	M48 x 200	480.200	1
M30 x 180	300.180	2	M36 x 260	360.260	1	M48 x 260	480.260	1
M30 x 200	300.200	2	M36 x 280	360.280	1	M48 x 300	480.300	1

① Size **b** is a guide value, it amounts on the **minimum** length of the threaded part.
 ② This size is **not** DIN standardised.
 Per diameter (d) are lengths (L) above the dotted line fully threaded. (L – b = max. 3P).
 For other sizes with full thread, see elsewhere in the section.
WARNING: electro-galvanizing of these products may cause hydrogen embrittlement.